

# LE-106HE

LUZ ESTROBOSCÓPICA DE ALTA EFICIENCIA  
HIGH-EFFICIENCY STROBE LIGHT

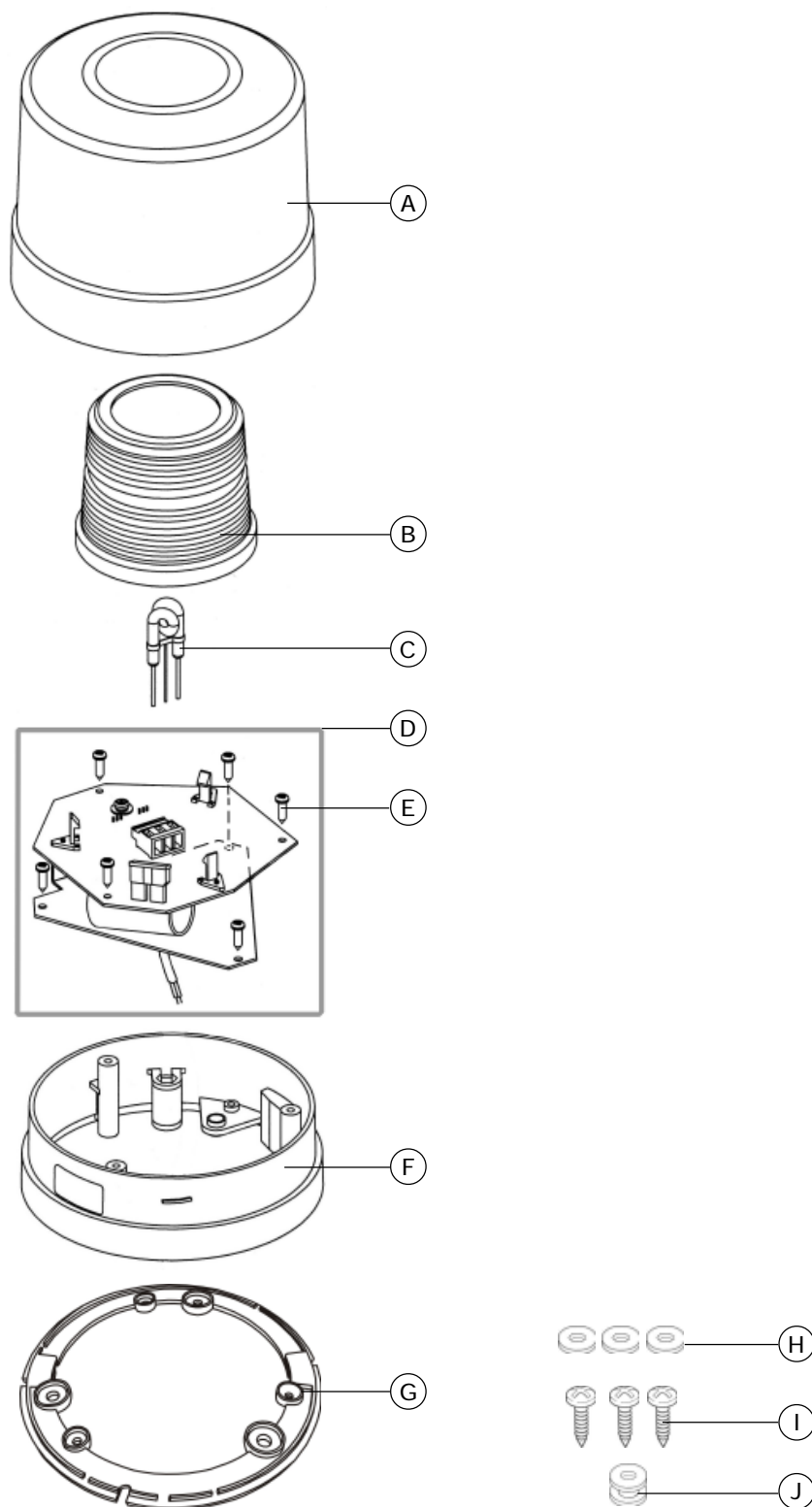

Item N.	Descripción / Description	Ref.	Cant. / Qty.
A	Lente D-164X130 ámbar R65 LE <i>LE R65 amber D-164X130 lens</i>	9133711-04REC	1
	Lente D-164X130 Azul R65 LE <i>LE R65 blue D-164X130 lens</i>	9133711-03REC	1
B	Lente Fresnel FBII cristal taladrada <i>Drilled clear Fresnel lens</i>	8133271	1
C	Lámpara estroboscópica LE-106HE <i>LE-106HE strobe lamp</i>	8233379REC	1
D	Conjunto circuito y soporte disipador LE-106HE <i>LE-106HE dissipator support &amp; circuit assembly</i>	8299408	1
E	Tornillo rosca chapa 4,2x13 DIN7981 alomado Philips <i>Philips curve-backed DIN7981 4,2x13 self-taping screw</i>	9027164	6
F	Base LE-106HE <i>LE-106HE base</i>	8233380REC	1
G	Junta adaptación prioritario 015 <i>015 Priority adaptation joint</i>	9133723	1
H	Arandela M05x15 DIN9021 <i>DIN9021 M05x15 washer</i>	9027788	3
I	Tornillo rosca chapa 4,2x25 DIN7981 Philips <i>Philips DIN7981 4,2x25 self-taping screw</i>	9027259	3
J	Pasacables ref.315 D5 <i>D5 ref.315 grommet</i>	9015032	1



Empresa certificada ISO / ISO certified Company

**FEDERAL SIGNAL VAMA, S.A**

Dr. Ferrán, 7 (08339) VILASSAR DE DALT,  
BARCELONA, SPAIN

Tel. (00) 93 741 79 49 (Spain)

Tel. (34) 93 741 79 41 (Int.)

Fax (34) 93 753 03 62

email: [service@vama.es](mailto:service@vama.es)

Web : [www.fedsig.vama.es](http://www.fedsig.vama.es)

**Delegación - Madrid**

Avda.Baviera, 13

(28028) MADRID

Tel. (34) 91 355 22 00

Fax (34) 91 355 35 61

email: [servicemad@vama.es](mailto:servicemad@vama.es)